

| Spec. | 7 | | 6 | | 5 | | 4 | | 3 | | 2 | | 1 | |
|----------|----------------------|-------------------------|------------------|---|---|---|--|------------------------|--------------|-----------|---|--|---|--|
| | mm Plunger Stroke | mm Jaw Stroke (Dia.) | Chucking Dia. mm | | Allowable hydraulic cylinder thrust kgf Max D.B. pull | Maximum clamping force kgf Max clamping force | Maximum number of revolutions r.p.m. Max speed | l kg·m ² | kg Weight | Confirmed | | | | |
| CBE-4212 | 4.5 | — | 42 | 4 | 3500 | 8000 | 7000 | — | 5.8 | | | | | |

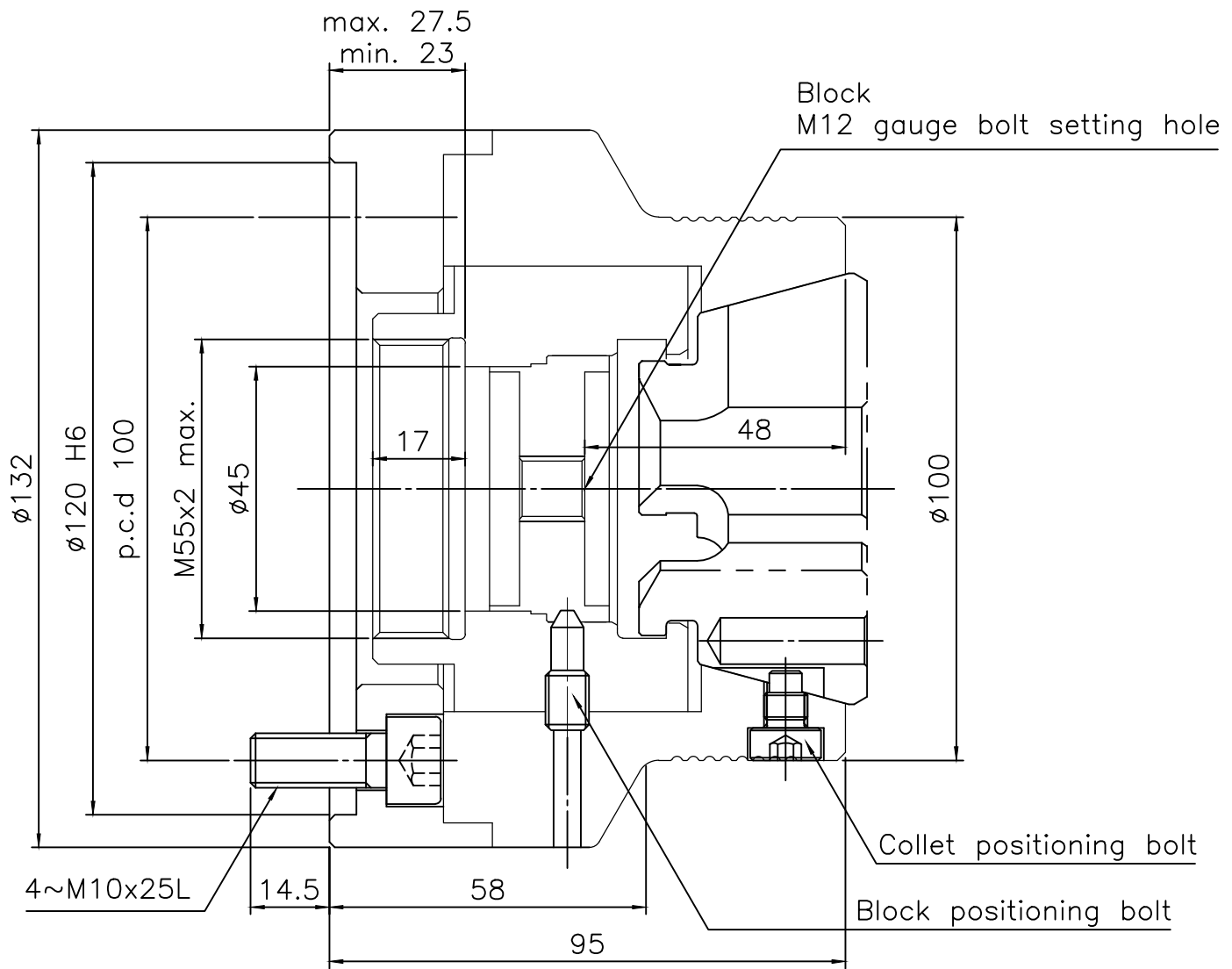

LEADER CHUCK INTERNATIONAL
+44 (0) 1827 700000
+353 (0)1 254 2555
INFORMATION@LEADERCHUCK.COM
LEADERCHUCK.COM

TITLE:
Pull-Back Collet Chuck with
Part Location Stop

DRAWING NO.:
A3\AG-CBE-4212

